

Advantages

of using holders with CoolStream® (coolant channel bore) are:

- Longer tool life
- More efficient chip removal
- Optimal coolant supply for slot, blind hole and finish machining
- Better dimensional accuracy of workpieces
- Better surface quality
- Higher process reliability

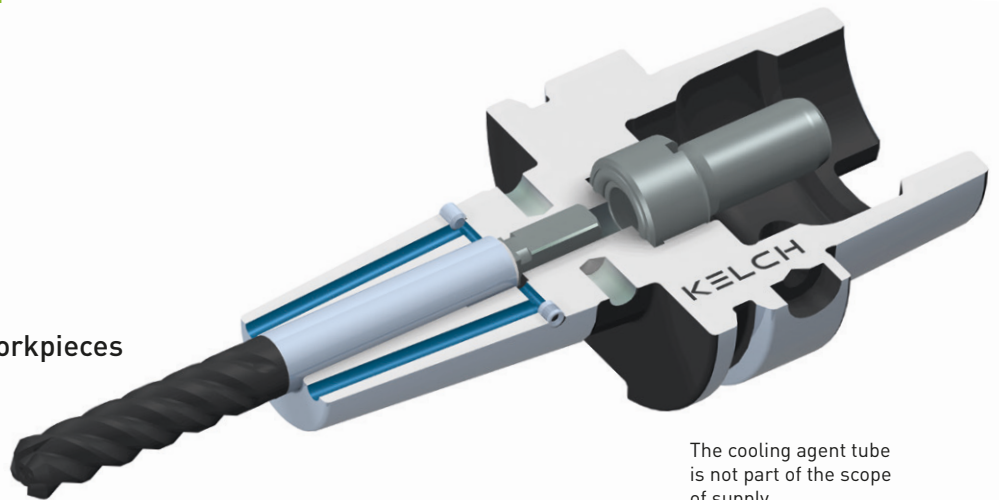

The cooling agent tube is not part of the scope of supply

CoolStream® tool holders available as standard catalogue items!

1. i-tec® shrink-fit chuck
(standard version / A-dimension 130 mm)
PSC 50-80, HSK-A 63, SK 40 (DIN 69871)

2. Weldon holders (standard version)
PSC 50/63, HSK-A 63

3. Shell end mill arbors (standard version)
HSK-A 63

All CoolStream® holders offered as recloseable version. Screws to close the bore available as additional option.
Further holders with coolant bores available on request!



Tool holder with CoolStream® in use.

A-dimension of 130 mm also available in addition to the standard version.

CoolStream®

Bringing the cooling stream to the point.

i-tec® shrink-fit chucks

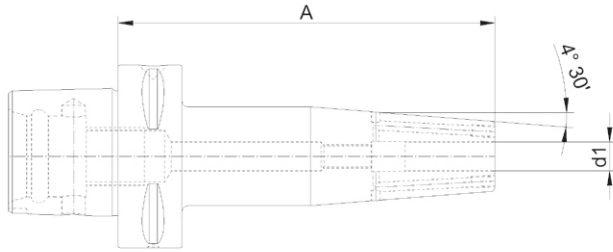

PSC interfaces

Article No.	Interface	d1	A
311.4001.383*	50	6	75
311.4471.383	50	6	130
311.4002.383*	50	8	75
311.4472.383	50	8	130
311.4003.383*	50	10	75
311.4473.383	50	10	130
311.4004.383*	50	12	75
311.4474.383	50	12	130
311.4005.383*	50	14	80
311.4475.383	50	14	130
311.4006.383*	50	16	80
311.4476.383	50	16	130
311.4007.383*	50	18	80
311.4477.383	50	18	130
311.4008.383*	50	20	85
311.4478.383	50	20	130
311.4001.384*	63	6	80
311.4471.384	63	6	130
311.4002.384*	63	8	80
311.4472.384	63	8	130
311.4003.384*	63	10	80
311.4473.384	63	10	130
311.4004.384*	63	12	80
311.4474.384	63	12	130
311.4005.384*	63	14	85
311.4475.384	63	14	130
311.4006.384*	63	16	85
311.4476.384	63	16	130
311.4007.384*	63	18	85
311.4477.384	63	18	130
311.4008.384*	63	20	85
311.4478.384	63	20	130
311.4009.384*	63	25	90
311.4479.384	63	25	130
311.4010.384*	63	32	95
311.4001.385*	80	6	85
311.4002.385*	80	8	85
311.4003.385*	80	10	85
311.4004.385*	80	12	85
311.4006.385*	80	16	90
311.4008.385*	80	20	90

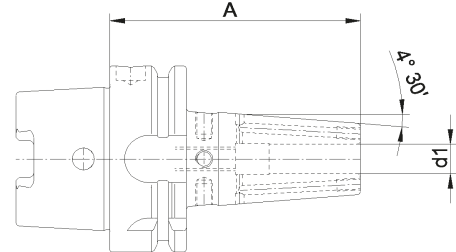

HSK interfaces

Article No.	Interface	d1	A
311.4353.322	63	10	70
311.4354.322	63	12	70
311.4356.322	63	16	75
311.4358.322	63	20	75
311.4359.322	63	25	85
311.4401.322	63	6	80
311.4471.322	63	6	130
311.4402.322	63	8	80
311.4472.322	63	8	130
311.4403.322	63	10	85
311.4473.322	63	10	130
311.4404.322	63	12	90
311.4474.322	63	12	130
311.4405.322	63	14	90
311.4475.322	63	14	130
311.4406.322	63	16	95
311.4476.322	63	16	130
311.4407.322	63	18	95
311.4477.322	63	18	130
311.4408.322	63	20	100
311.4478.322	63	20	130
311.4409.322	63	25	115
311.4479.322	63	25	130

* non-recloseable CoolStream® tool holders

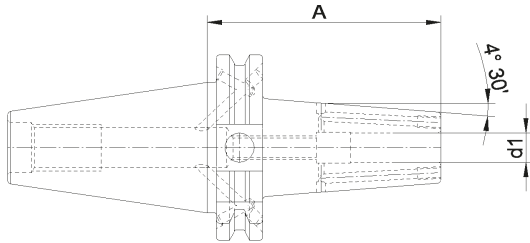

SK interfaces

Article No.	Interface	d1	A
311.4353.292	40	10	65
311.4354.292	40	12	65
311.4356.292	40	16	65
311.4358.292	40	20	65
311.4359.292	40	25	75
311.4401.292	40	6	80
311.4471.292	40	6	130
311.4402.292	40	8	80
311.4472.292	40	8	130
311.4403.292	40	10	80
311.4473.292	40	10	130
311.4404.292	40	12	80
311.4474.292	40	12	130
311.4405.292	40	14	80
311.4475.292	40	14	130
311.4406.292	40	16	80
311.4476.292	40	16	130
311.4407.292	40	18	80
311.4477.292	40	18	130
311.4408.292	40	20	80
311.4478.292	40	20	130
311.4409.292	40	25	100
311.4479.292	40	25	130

Weldon holders

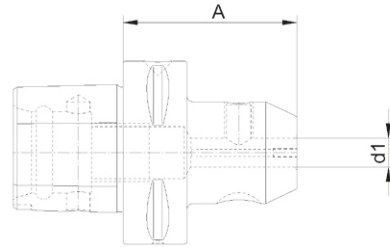

PSC interfaces

Article No.	Interface	d1	A
420.4401.383	50	6	50
420.4402.383	50	8	50
420.4403.383	50	10	55
420.4404.383	50	12	60
420.4405.383	50	14	60
420.4406.383	50	16	60
420.4407.383	50	18	60
420.4408.383	50	20	60
420.4409.383	50	25	85
420.4401.384	63	6	55
420.4402.384	63	8	55
420.4403.384	63	10	60
420.4404.384	63	12	60
420.4405.384	63	14	60
420.4406.384	63	16	65
420.4407.384	63	18	65
420.4408.384	63	20	65
420.4409.384	63	25	80
420.4410.384	63	32	90

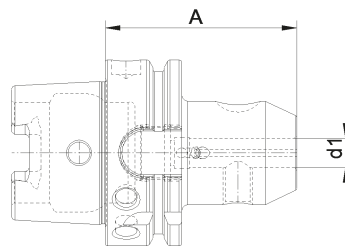

HSK interfaces

Article No.	Interface	d1	A
420.4401.322	63	6	65
420.4402.322	63	8	65
420.4403.322	63	10	65
420.4404.322	63	12	80
420.4406.322	63	16	80
420.4408.322	63	20	80
420.4409.322	63	25	110
420.4410.322	63	32	110

Shell end mill arbors

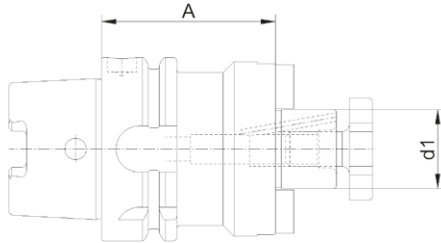

HSK interfaces

Article No.	Interface	d1	A
579.4009.322*	63	16	50
579.4039.322*	63	16	100
579.4049.322*	63	16	160
579.4001.322*	63	22	50
579.4031.322*	63	22	100
579.4041.322*	63	22	160
579.4002.322*	63	27	60
579.4032.322*	63	27	100
579.4042.322*	63	27	160
579.4003.322*	63	32	60
579.4033.322*	63	32	100
579.4043.322*	63	32	160
579.4004.322*	63	40	60
579.4034.322*	63	40	100

* non-recloseable CoolStream® tool holders